

MAP OF SHEPHERD CEMENT WORKS

I hereby certify that on the 6th day of April 1884 I surveyed for the Shepherds Association a parcel of ground situated on section 25 Township 22 North range 20 East of the principal meridian in Iron Co. Mo., to be known & styled by the name of **Shepherds Cement Works** of which the accompanying is a correct plan delineated as follows, first by a boundary enclosing five acres new part the blocks are 8 by 80 ft and alleys 8 ft wide, and B. & W. 6 ft - the old part (now occupied & designated by blue shading) there is one row of blocks 9 by 30 ft, one row of five alleys, three 31 ft wide & two of 6 ft, there is an avenue near the corner 11 ft wide bearing N. 82 E. and one on each side of 15 ft in width.

Done by **Jno. Harrel** surveyor

W. 88 2 6 26.7

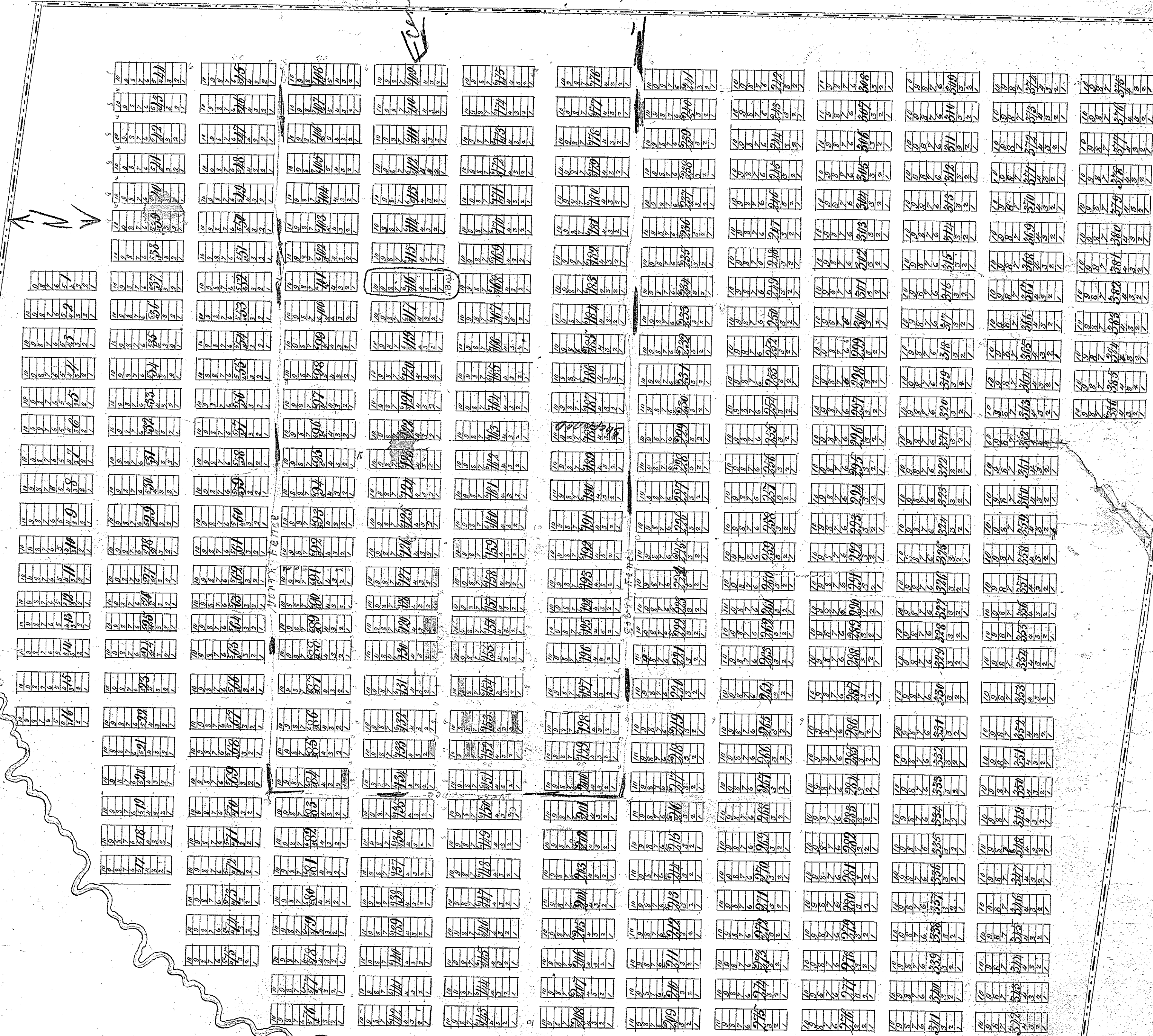

Scale 30 Feet to 1 inch

W. 88 2 6 26.7

S. W. Co. 30 feet